

SURVEYOR'S REAL PROPERTY REPORT PART 1

PLAN OF LOTS 3, 4 AND 8

PLAN 65M-3214

TOWN OF RICHMOND HILL

REGIONAL MUNICIPALITY OF YORK

SCALE 1:300
10m 5m 0 10m 20m 30m

RADY-PENTEK & EDWARD SURVEYING LTD., O.L.S., 2000.

METRIC

DISTANCES SHOWN ON THIS PLAN ARE IN METRES AND
CAN BE CONVERTED TO FEET BY DIVIDING BY 0.3048.

SURVEYOR'S CERTIFICATE

I CERTIFY THAT:

- THIS SURVEY AND PLAN ARE CORRECT AND IN ACCORDANCE
WITH THE SURVEYS ACT, THE SURVEYORS ACT AND THE LAND
TITLES ACT AND THE REGULATIONS MADE UNDER THEM.
- THE SURVEY WAS COMPLETED ON THE 27TH DAY OF Nov., 2000

DATE Dec. 6, 2000.

JOSEPH RADY-PENTEK
ONTARIO LAND SURVEYOR

NOTES

- DENOTES MONUMENT FOUND
- DENOTES MONUMENT SET
- SIB DENOTES STANDARD IRON BAR
- IB DENOTES IRON BAR
- PL DENOTES PLAN 65M-3214
- D.U.C. DENOTES DWELLING UNDER CONSTRUCTION
- P.I.N. DENOTES PROPERTY IDENTIFIER NUMBER
- P DENOTES PORCH
- (RPE) DENOTES RADY-PENTEK & EDWARD SURVEYING LTD., O.L.S.

ALL FOUND MONUMENTS BY VLADIMIR KRCDMAR LTD., O.L.S.

ALL TIES TO CONCRETE FOUNDATIONS.

BEARINGS ARE ASTRONOMIC AND ARE REFERRED TO THE
SOUTH LIMIT OF HUMBERLAND DRIVE AS SHOWN ON
PLAN 65M-3214 HAVING A BEARING OF N73°03'30"E.

HUMBERLAND DRIVE

(BY PLAN 65M - 3214)

BLOCK 129
(0.30 RESERVE)

ASSOCIATION OF ONTARIO
LAND SURVEYORS
PLAN SUBMISSION FORM
1334233

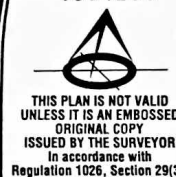

THIS PLAN IS NOT VALID
UNLESS IT IS AN EMBOSSED
ORIGINAL COPY
ISSUED BY THE SURVEYOR
In accordance with
Regulation 1026, Section 29(3).

2 STOREY
BRICK
DWELLING

LOT 8

P.I.N.
03206-0771

PL&MEAS
12.200

LOT 7

LOT 6

LOT 5

LOT 4

P.I.N.
03206-0767

PL&SET
12.200

LOT 3

P.I.N.
03206-0766

PL&MEAS
12.200

LOT 2

LOT 1

LOT 40

LOT 68, CONCESSION 1, WEST OF YONGE STREET

PART 2 (SURVEY REPORT)

REGISTERED EASEMENTS AND/OR RIGHT-OF-WAYS: NONE

THIS PLAN DOES NOT CERTIFY COMPLIANCE WITH ZONING BY-LAWS

THIS REPORT WAS PREPARED FOR
SALISBURY HOMES
AND THE UNDERSIGNED ACCEPTS NO
RESPONSIBILITY FOR USE BY OTHER PARTIES.

© RADY-PENTEK & EDWARD SURVEYING LTD., O.L.S. 2000



RADY-PENTEK & EDWARD SURVEYING LTD.
ONTARIO LAND SURVEYORS

465 WILSON AVENUE, DOWNSVIEW, ONTARIO
635-5000

DRAWN: D.M.
JOB No. 98-103

CHECKED: J.R.P.
ACAD No. 3214-3